

D-Code Built-in basin # 0338560000

| < 560 mm > |

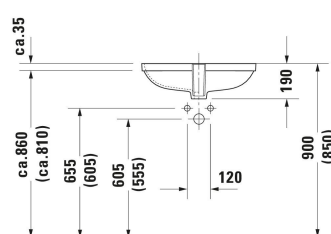
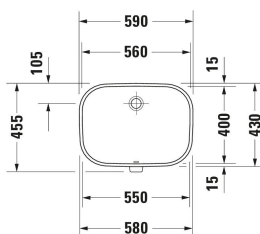

Built-in basin	Dimension	Weight	Order number
Washbasin version: Installation, 560x400 mm, Tap hole platform: No, Overflow: Yes, Type of mounting: undercounter, Incl. fixings for installation in wooden consoles			
Colors			
00 White Alpin			
Variant			
<input checked="" type="checkbox"/> Washbasin version: undercounter, 560x430 mm, White High Gloss	560x210 mm	9.400 kg	0338560000
Accessory			
Push-open waste Suitable for washbasin with overflow, Ø 63,5 mm	Ø 63.5 mm	0.34 kg	005052
Fixation Type of installation: In natural stone console, Suitable for Built-in basin	10 x 40 mm	0.2 kg	005028
Recommended faucets			
Single lever basin mixer L Ceramic cartridge, Height: 262 mm, Spout reach: 136 mm, Connection type for water supply connection: Flexible connecting hoses, Dimension of connection hose: 3/8", Spray mode: Normal spray, Aerator adjustable, recommended operating pressure: 1 - 5 bar, Noise class: I, Handle version: lever handle, 166 x 40 mm	166 x 40 mm		C11030001
Single lever basin mixer XL Ceramic cartridge, Height: 322 mm, Spout reach: 166 mm, Connection type for water supply connection: Flexible connecting hoses, Dimension of connection hose: 3/8", Spray mode: Normal spray, Aerator adjustable, recommended operating pressure: 1 - 5 bar, Noise class: I, Handle version: lever handle, 197 x 41 mm	197 x 41 mm		C11040001
Single lever basin mixer Ceramic cartridge, Height: 74 mm, Connection type for water supply connection: Basic Set, Spray mode: Normal spray, Aerator adjustable, Including trim parts, recommended operating pressure: 1 - 5 bar, Noise class: I, Handle version: lever handle, Unified Water Label (UWL) Class: 1, 173 x 174 mm	173 x 174 mm		C11070003

D-Code Built-in basin # 0338560000

| < 560 mm > |

Single lever basin mixer Ceramic cartridge, Height: 74 mm, Connection type for water supply connection: Basic Set, Spray mode: Normal spray, Aerator adjustable, Including trim parts, recommended operating pressure: 1 - 5 bar, Noise class: I, Handle version: lever handle, Unified Water Label (UWL) Class: 1, 173 x 225 mm	173 x 225 mm	C11070004
Single lever basin mixer XL Chrome, Ceramic cartridge, Height: 295 mm, Spout reach: 180 mm, Connection type for water supply connection: Flexible connecting hoses, Dimension of connection hose: 3/8", Spray mode: Normal spray, Aerator, Temperature limit adjustable, recommended operating pressure: 1 - 5 bar, Handle version: lever handle, Unified Water Label (UWL) Class: 1, 222 x 43 mm	222 x 43 mm	A11040001
Single lever basin mixer XL Chrome, Ceramic cartridge, Height: 295 mm, Spout reach: 180 mm, Connection type for water supply connection: Flexible connecting hoses, Dimension of connection hose: 3/8", Spray mode: Normal spray, Aerator, Temperature limit adjustable, recommended operating pressure: 1 - 5 bar, Handle version: lever handle, Unified Water Label (UWL) Class: 1, 222 x 43 mm	222 x 43 mm	A11040002
2 Hole basin mixer electronic XL Height: 253 mm, Spout reach: 180 mm, Temperature control: Ceramic cartridge, Aerator adjustable, Connection type for water supply connection: Flexible connecting hoses, Dimension of connection hose: 3/8", Temperature limit adjustable, Flow rate (3 bar): 5 l/min, Adjustable water run time, Hygienic flush, Spray mode: Normal spray, Incl. spout, Incl. control unit, Incl. operating unit, Operation type: Controller, without pop-up waste set, Electronic control: power supply, Protection type: IPX4, 230 x 45 mm	230 x 45 mm	D11110008
2 Hole basin mixer electronic XL Height: 253 mm, Spout reach: 180 mm, Temperature control: Ceramic cartridge, Aerator adjustable, Connection type for water supply connection: Flexible connecting hoses, Dimension of connection hose: 3/8", Temperature limit adjustable, Flow rate (3 bar): 5 l/min, Adjustable water run time, Hygienic flush, Spray mode: Normal spray, Incl. spout, Incl. control unit, Incl. operating unit, Operation type: Controller, without pop-up waste set, Electronic control: power supply, Protection type: IPX4, 230 x 45 mm	230 x 45 mm	D11110007
2 Hole basin mixer XL Height: 253 mm, Spout reach: 180 mm, Temperature control: Ceramic cartridge, Aerator adjustable, Connection type for water supply connection: Flexible connecting hoses, Dimension of connection hose: 3/8", Flow rate (3 bar): 5 l/min, Spray mode: Normal spray, Operation type: Mechanical, without pop-up waste set, 230 x 45 mm	230 x 45 mm	D11130002
2 Hole basin mixer XL Height: 253 mm, Spout reach: 180 mm, Temperature control: Ceramic cartridge, Aerator adjustable, Connection type for water supply connection: Flexible connecting hoses, Dimension of connection hose: 3/8", Flow rate (3 bar): 5 l/min, Spray mode: Normal spray, Operation type: Mechanical, without pop-up waste set, 230 x 45 mm	230 x 45 mm	D11130009

All drawings contain the necessary measurements which are subject to standard tolerances. They are stated in mm and are non-binding. Exact measurements, in particular for customised installation scenarios, can only be taken from the finished piece.