

## LAUFEN PRO

## Wall-hung WC, washdown, with flushing rim



## DIMENSIONS

Length	530 mm
Width	360 mm
Height	345 mm

## COLOUR AND FINISH

☐ 000 White

## OPTIONS

000 - standard option

## SPECIFICATION TEXT

Wall-hung WC pan washdown LAUFEN PRO, sanitary ceramic for concealed cistern, EN 997, EN 33, 5/3-l-flush, dimensions 360 x 530 x 340 mm concealed trap, concealed fixation.

Special feature: concealed surfaces directing water are fully glazed throughout, vacuum checked.

Further options / accessories: Surface refinement LCC (only white), WC seat and cover H893955, H896950, H898965, WC seat and cover with automatic lowering H891601, H893959, H896951, H898966

## MOUNTING ACCESSORIES INCLUDED

Laufen EasyFit 2.0 system M12, order no. H893828

## MOUNTING ACCESSORIES EXCLUDED

Antinoise set, order no. H892695

Stone screw fastening kit M12

Average water consumption (L.) : 3.72

Flushing system : Washdown

Installation type : Wall-hung

Net weight (kg) : 24

Outlet type : Horizontal

Rim type : Closed

Shape : Round

Style : Neutral

Water Inlet System : Back Inlet

TECHNICAL DRAWINGS

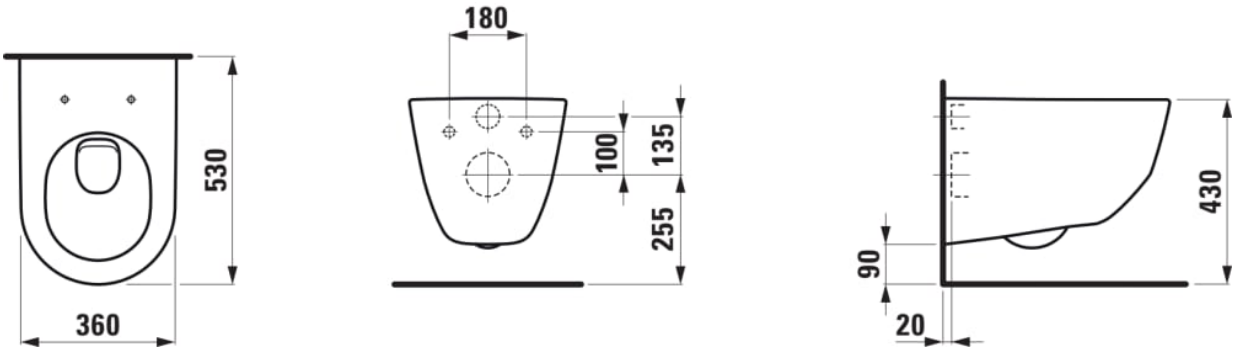

COMPATIBLE WITH



WC seat and cover,  
removable, with lowering  
system, chrome hinges

H891601...0001



WC seat and cover  
'universal', for hollow space  
fixing

H893955...0001



Seat ONLY for wall-hung  
WC H820956, H820965,  
without cover

H893957...0001



WC seat and cover  
'universal', removable, with  
lowering system, for hollow  
space fixing

H893959...0001



WC seat and cover,  
removable, stainless steel  
hinges

H896950...0001



WC seat and cover,  
removable, with lowering  
system, stainless steel  
hinges

H896951...0001



WC seat and cover, 'slim'

H8989600...001



WC Seat and cover, 'slim',  
removable, stainless steel  
hinges

H898965...0001



WC seat and cover,  
removable, with lowering  
system, chrome hinges

H898966...0001



Fixation LAUFEN EASYFIT  
2.0 M12, ROD 250MM  
BLUE

H8938280000001



## LAUFEN PRO

LAUFEN PRO is a comprehensive bathroom range, which offers the ideal solution for every spatial situation and requirement and also reflects the building values of the current generation. Industrial design is the modern answer to the once revolutionary idea that everyone has a right to enjoy beautiful forms. Good design is now no longer a right reserved for the most affluent customers. Modern methods of industrial production and designers such as Peter Wirz of Vetica, who put optimum manufacturing feasibility at the forefront of their creative processes, make such sanitary ware ranges as LAUFEN PRO possible. This does not just benefit the designer, more importantly, it also benefits the customer.

